

Spec House – Woodland Cir (Timber Ridge Lot #28)

Coming in
JUNE 2024



This 1,763 square foot ranch home is conveniently located just minutes away from Minocqua in the Timber Ridge subdivision on the 6th hole tee box. The split floorplan has many functional features that you'd like to see in a new home including:

- 4 Bedroom, 2 Bath
- Main Floor Laundry
- Vaulted Ceilings
- Full Basement with 9' Tall Ceilings and Bath Rough-In for Future Finishing
- Energy Efficient Building Products
- Marvin Windows
- Fireplace
- 3 Stall Attached Garage
- Vinyl Siding (Maintenance Free)
- Architectural Shingles
- Covered Entry Porch
- Heated Seasonal Pool and Pickleball Courts
- 18 Hole Golf Course
- Access to Bearskin State Trail
- Subdivision Restaurant

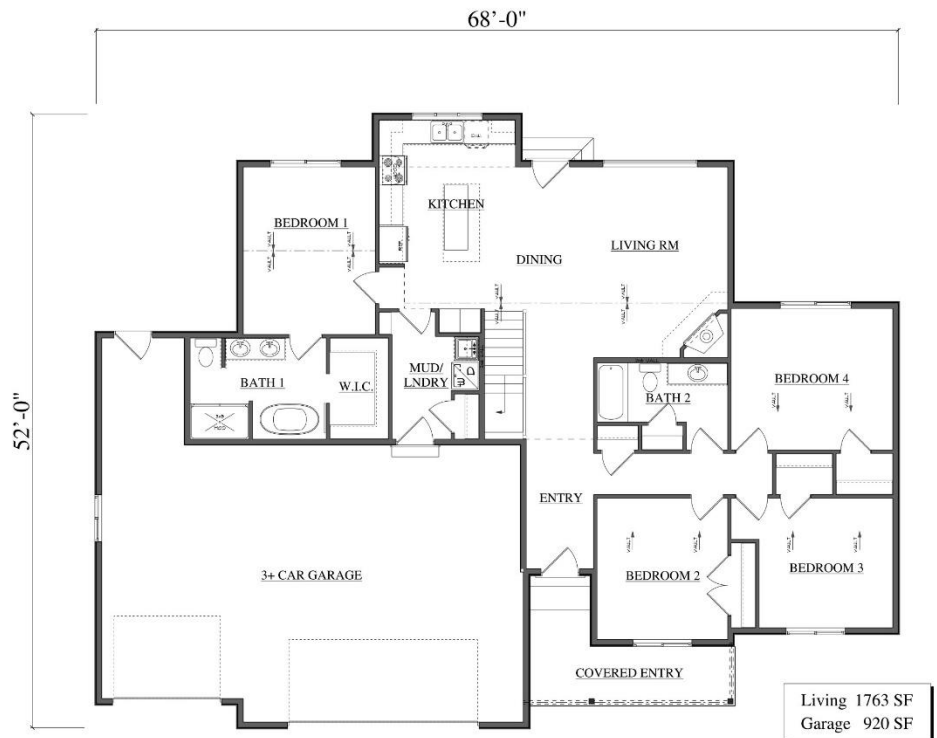

**** Availability for custom exterior and interior color selections - stop by Everest Custom Homes to see Chad or Scott for more details. ****

See a Sales Professional For More Details



Everest Custom Homes, Inc.

Hwy 51 S and Lee Rd • PO Box 779

Minocqua, WI 54548

(715) 356-3636

www.everestcustomhomes.com